

Materials:

- Panels - 6mm ACM
- Posts - 4"x6" x14' wood
- Braces - 2"x4" x8' wood

- NOTES:
1. ALL TEMPORARY GROUND SIGNS SHALL NOT INTERFERE WITH CLEAR VIEW SIGHT TRIANGLES
 2. SIDE AND REAR SETBACK NOT ADJACENT TO A SIDEWALK OR RIGHT-OF-WAY. ALL TEMPORARY GROUND SIGNS SHALL BE LOCATED A DISTANCE EQUAL TO OR GREATER TO THEIR HEIGHT FROM ANY INTERIOR SIDE OR REAR PROPERTY LINE.
 3. FRONT AND STREET SIDE SETBACKS AND OTHER SETBACK ADJACENT TO A SIDEWALK OR RIGHT-OF-WAY. ALL TEMPORARY GROUND SIGNS SHALL BE LOCATED AT LEAST THREE FEET FROM THE BACK OF THE SIDEWALK OR RIGHT-OF-WAY, WHICHEVER IS GREATER, AND FROM ALL DRIVEWAYS AS MEASURED FROM THE BACK OF THE CURB.

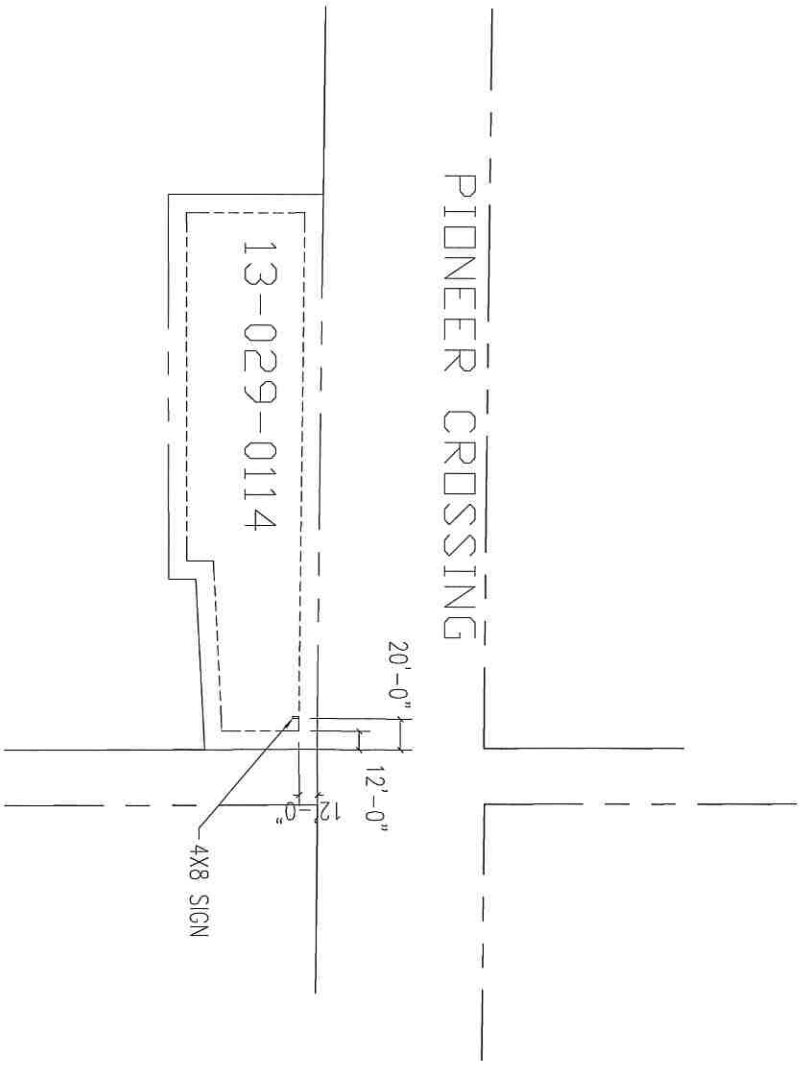

PLOT PLAN
 GROUND SIGN @
 PIONEER CROSSING
 & 2300 W

